

WITHOUT FIRST GETTING WRITTEN PERMISSION OF ROCKFORD ACROMATIC PRODUCTS CO.

ACROMATIC PRODUCTS CO. IT IS SUPPLIED TO YOU WITH CONFIDENTIAL INFORMATION AND

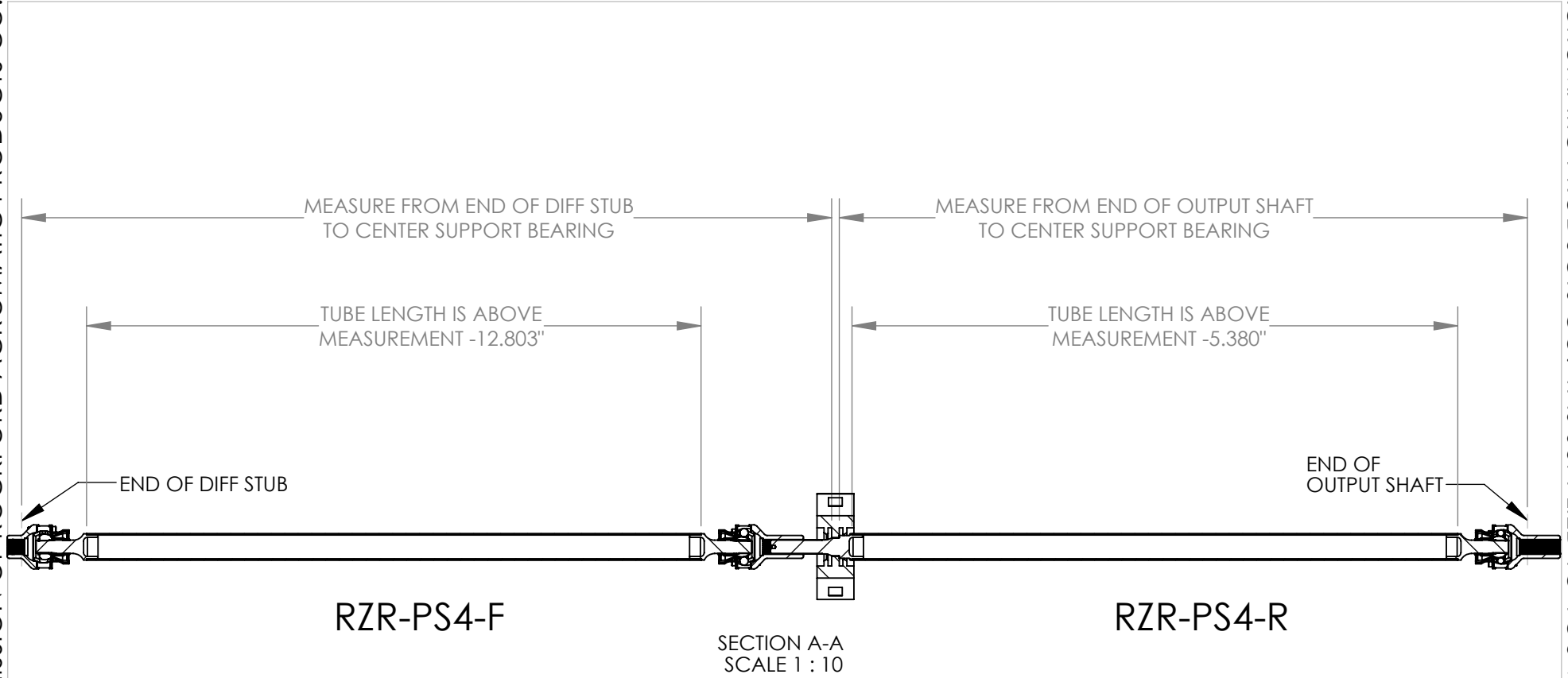

PACKAGE	<input type="checkbox"/>	UNLESS OTHERWISE SPECIFIED:	NAME	DATE
LASER MARK	<input type="checkbox"/>	DATE PRINTED 2/28/2018	DRAWN	JBP
FINISH	<input type="checkbox"/>	DIMENSIONS ARE IN INCHES	REVISED	
POLISH	<input type="checkbox"/>	TOLERANCES:	DWG. NO.	
THREAD ANNEAL	<input type="checkbox"/>	ANGULAR: ± 2 DEGREES	RZR-PS4	
STRAIGHTEN	<input type="checkbox"/>	TWO PLACE DECIMAL ± .020	PART NAME	
		THREE PLACE DECIMAL ± .010	MATERIAL	
		125 SURFACE FINISH		
		.010 PERPENDICULARITY		
		.010 CONCENTRICITY		
		CORNER BREAKS .010/.020		
		HEAT TREATMENT	GROUP	

# RZR-PS4-F

ITEM NO.	PART NUMBER	DESCRIPTION	QTY.
1	D9426	XP1000 TUBE STUB	2
2	475-10A	BOOT ASSEMBLY - VOLVO 78MM	2
3	CVJ9392	XP PROP SHAFT HSG	2
4	D10074	GASKET - PROP SHAFT	4
5	D8952	XP1000 PROP FLG	1
6	D9152	XP1000 PROP FLG MAIN CASE	1
7	D9694	BOOT ADAPTER	2
8	TUBE 1.75X.095 CHROMO FOR RZR-PS4-F		1
9	MCM-9563K154	FREEZE PLUG 1 1/8"	2
10	MCM-98585A118	EXT SR 7/8" HD	2
11	MCM-91251A462	1/4-28 X .25 SHCS	12
12	MCM-91271A570	1/4-28 X .75 12 PT W PATCH	12

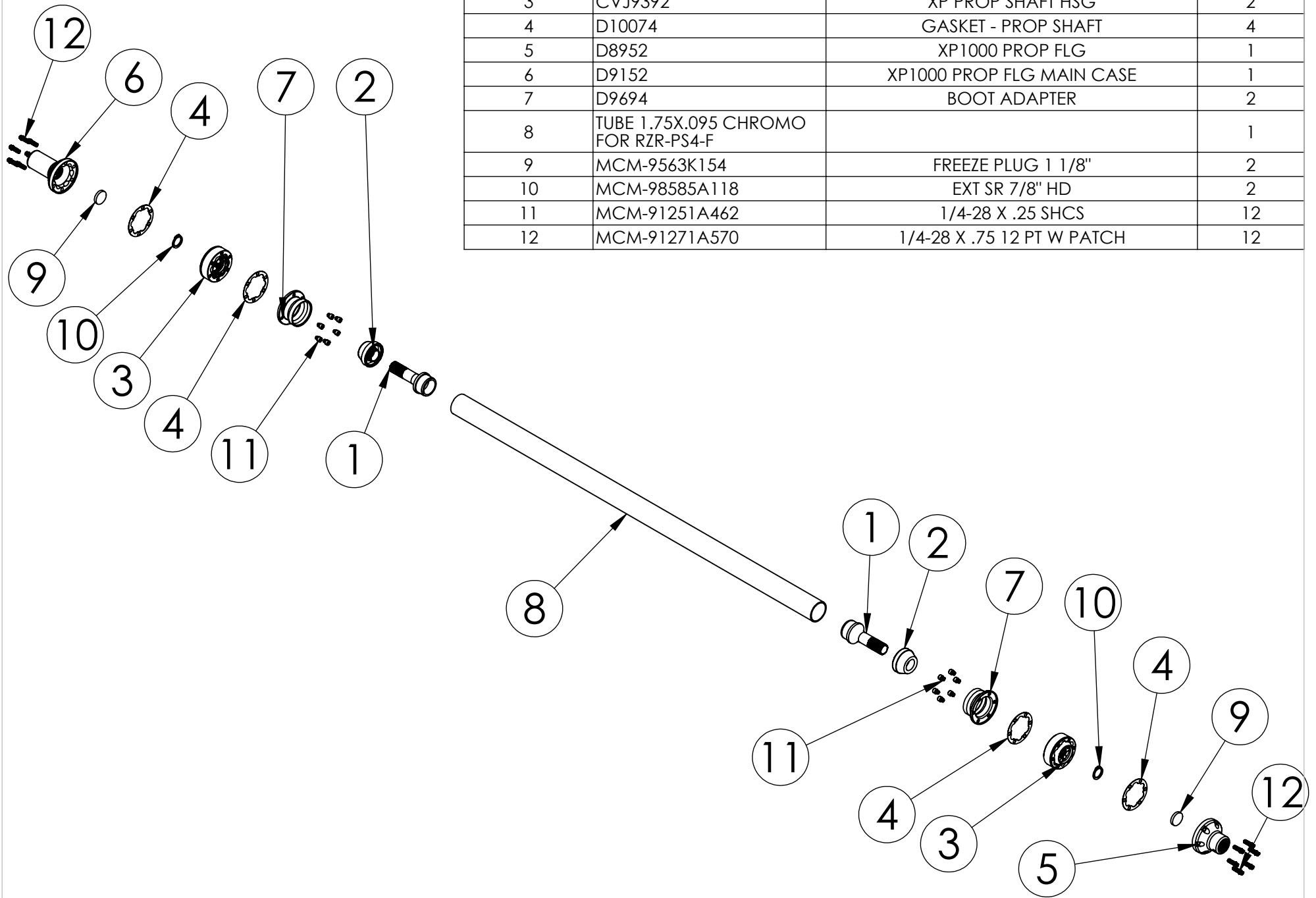

# RZR-PS4-R

ITEM NO.	PART NUMBER	DESCRIPTION	QTY.
1	D9015		1
2	455-56	CENTER SUPPORT BEARING	1
3	475-10A	BOOT ASSEMBLY - VOLVO 78MM	1
4	CVJ9392	XP PROP SHAFT HSG	1
5	D10074	GASKET - PROP SHAFT	2
6	D9152	XP1000 PROP FLG MAIN CASE	1
7	MCM-9563K154	FREEZE PLUG 1 1/8"	1
8	D9694	BOOT ADAPTER	1
9	D9426	XP1000 TUBE STUB	1
10	TUBE 1.75X.095 CHROMO FOR RZR-PS4-R		1
11	MCM-91251A462	1/4-28 X .25 SHCS	6
12	MCM-91271A570	1/4-28 X .75 12 PT W PATCH	6
13	MCM-98585A118	EXT SR 7/8" HD	1

